



## FMCT6 OIL CATCH CAN FITTING INSTRUCTIONS



Please thoroughly read through and familiarise yourself with these instructions in their entirety prior to beginning any part of the installation process of any component. Please also ensure the vehicle and engine has cooled down sufficiently to avoid risking possible skin burns or other injury.

### **TOOLS NEEDED:**

Flat blade Screwdriver  
T25 Torx Drive Screwdriver  
7mm Socket and Ratchet

1. Open the bonnet and locate the engine cover it is held in place on rubber mounts, simply pull upwards to remove it from the engine.



2. Next remove the vehicles air box, release the hose clamp using a 7mm socket and ratchet or flat blade screwdriver. Unplug the MAF sensor by depressing the retaining clip. The air box will now pull out of the engine bay.

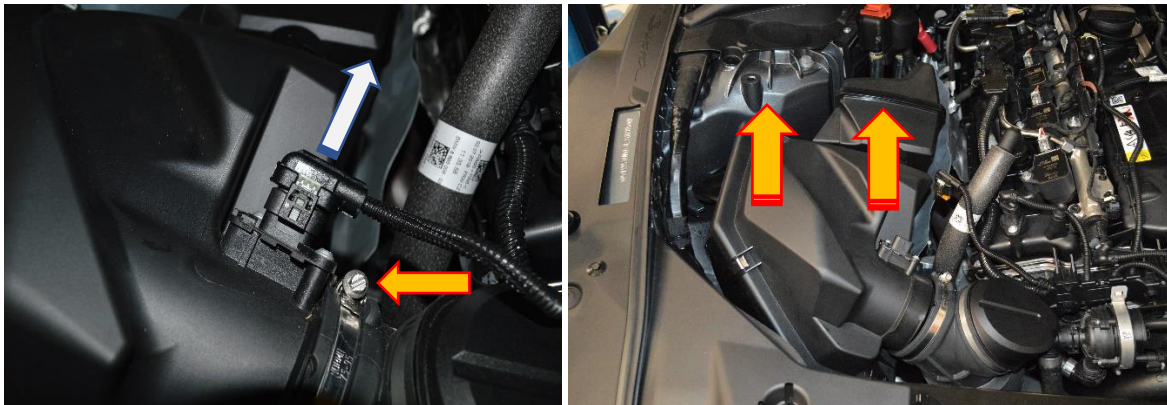

3. Locate the breather hose on top of the cam cover, squeeze the sides of the Norma fitting to release it.

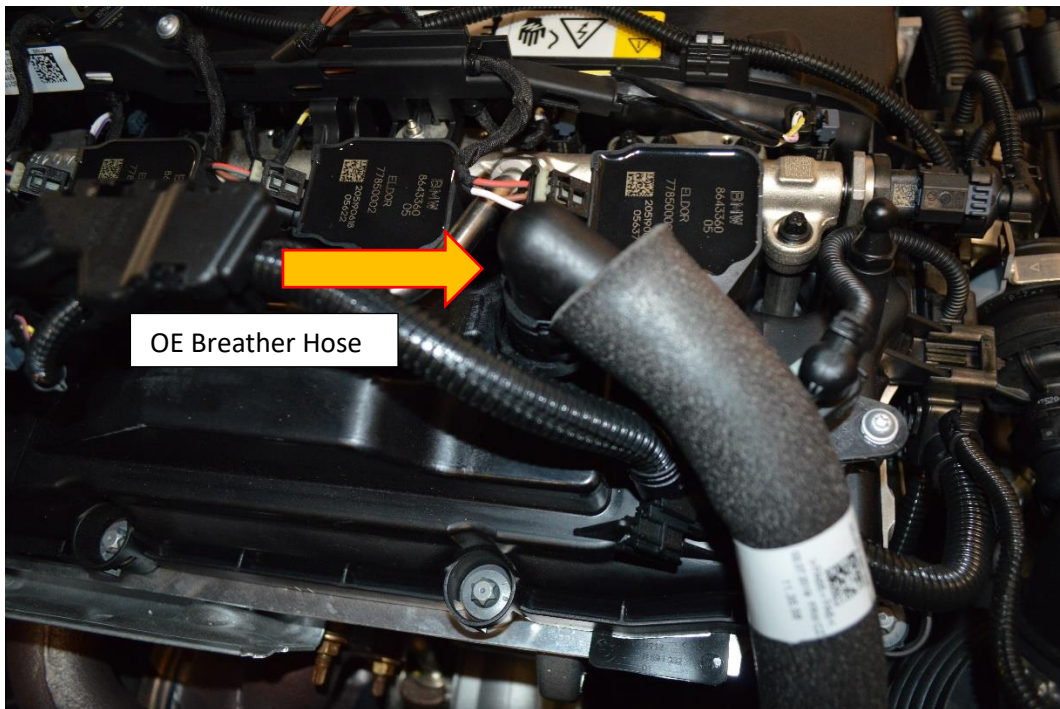

4. At the other end of the breather pipe you will see it has a Y fitting, disconnect the smaller breather pipe by releasing the Norma fitting as in the previous step. To remove the remaining breather pipe from the intake hose, release the retaining clip with the use of a flat blade screwdriver.

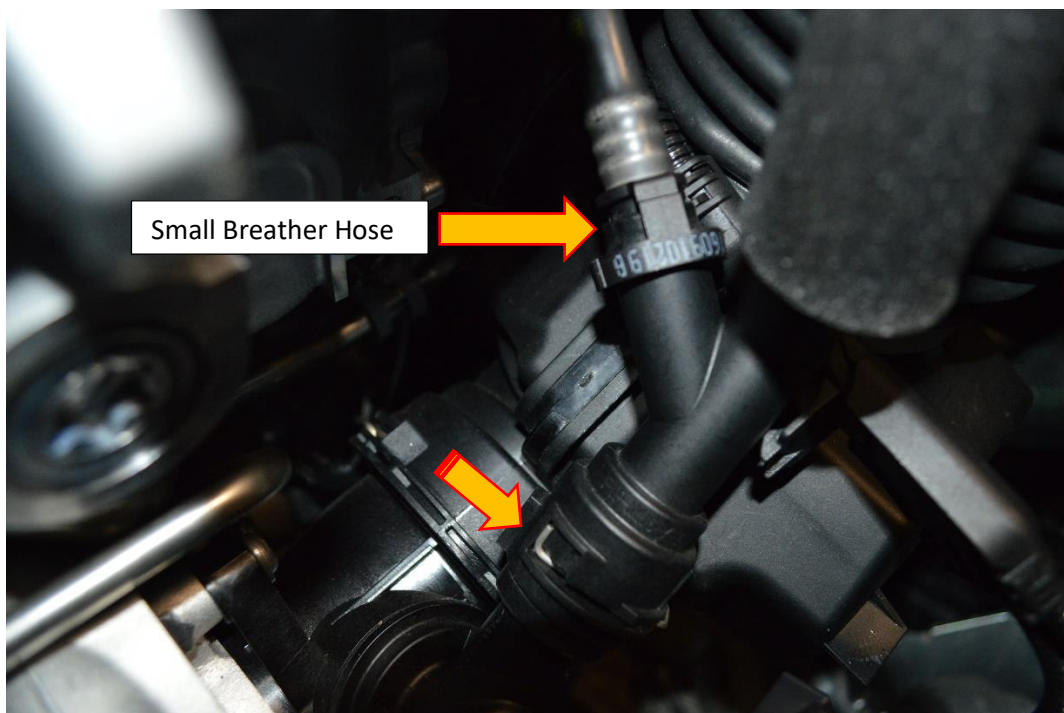

5. With the breather pipe removed from the vehicle the next step is to remove the O-ring from inside of the Y breather pipe end. Use a plastic trim tool or flat blade screwdriver to prise the O-ring from its housing, be careful not to damage the O-ring when doing this.



6. Insert the O-ring removed from the previous step into the O-ring groove in the Forge Breather adaptor.





7. Remove the original retaining clip from the OE breather pipe, prise it out with the use of a flat blade screwdriver.



8. Insert the Forge machined breather adaptor onto the intake pipe, connect the small breather pipe to the smaller spout. Fit the LONGER hose from the FMCT6 kit with 45 degrees Norma fitting to the remaining spout.

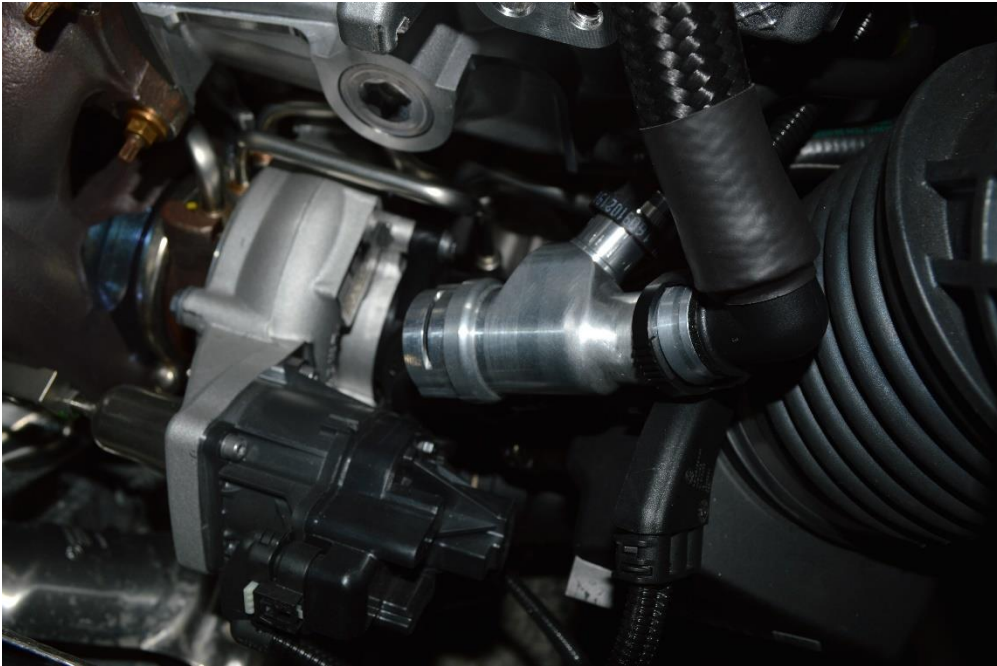

9. Insert the retaining clip removed in step 7, this will just slide into place.

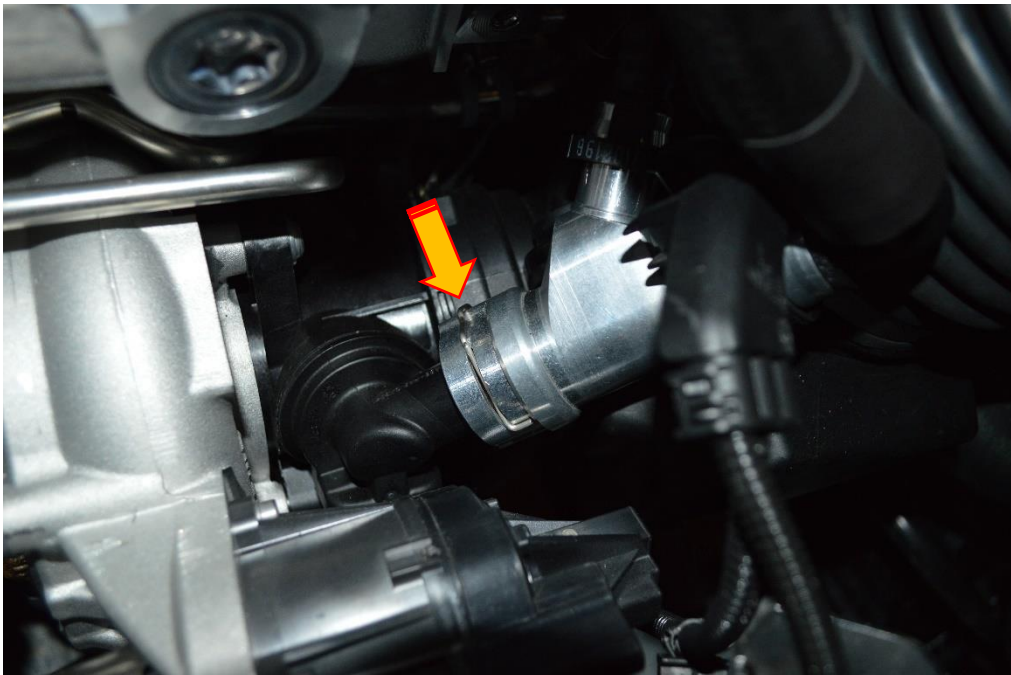

10. Fit the remaining shorter hose to the cam cover breather spout. Remove the fastener located next to the jump start point, use a T25 Torx drive to do this.

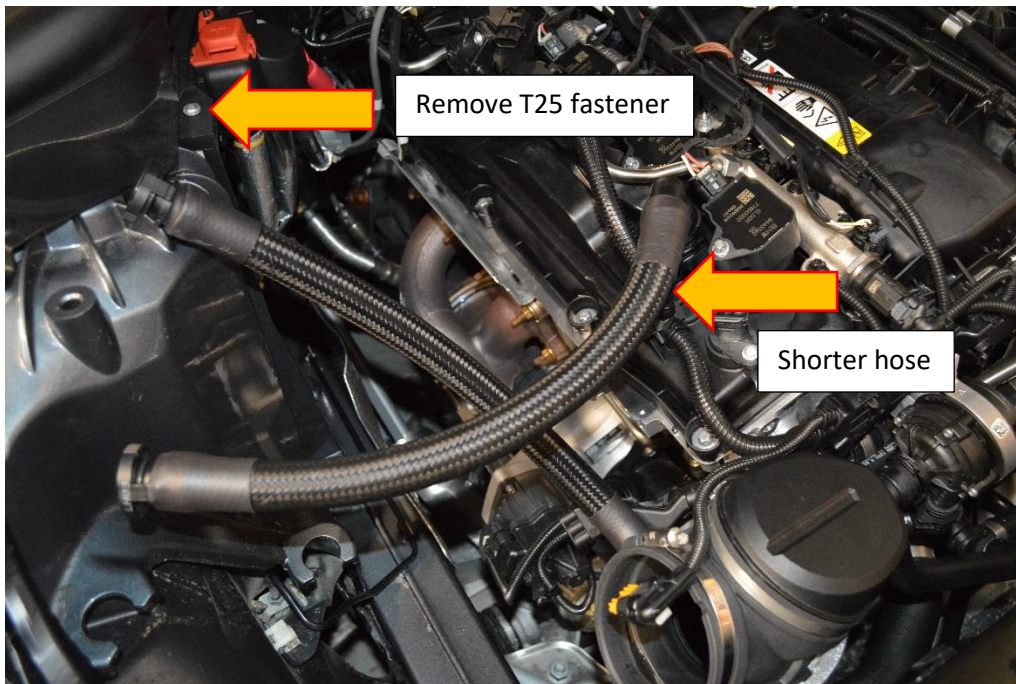

11. Take the Catch can from FMCT6 kit and fix into position with the removed fastener from the previous step.



12. Re install the air box and engine cover back into position, to do this just follow steps 1-2 in reverse order.

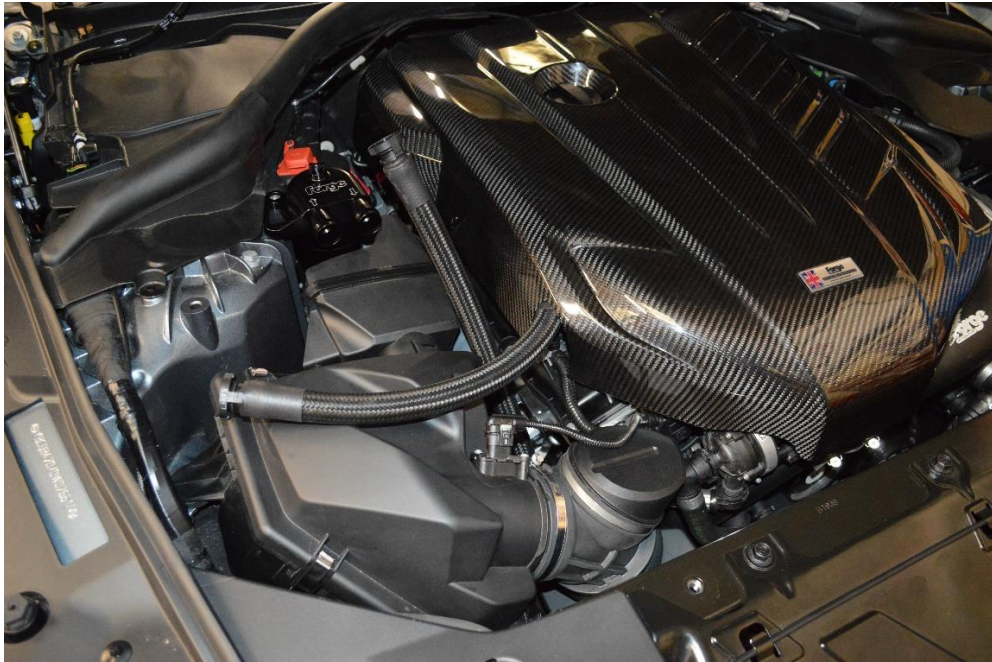

13. Fit the breather hoses to the catch can, the hose from the cam cover locates to the IN and the hose connected to the intake pipe locates to the OUT of the catch can.



14. Your install is now complete. You may now take the Vehicle for drive.



**Please note:**

**We advise frequent checks initially until you are familiar with the number of contaminants the catch can collects from your engine.**

**For trouble free engine breathing always drain when the level indicator on the dipstick is reached.**